

Install Your Adapter

Chapter Objectives

This chapter describes the procedures for installing your adapter, including how to:

- determine power requirements
- set the network address switches
- install the ControlNet adapter
- wire the ControlNet adapter
- connect programming terminals to the network via the NAP
- install the I/O modules
- install a replacement adapter to an existing system

Determine Power Requirements

The 1734-ACNR adapter requires a typical 24V dc power supply with a maximum of 10.2 watts of power @ 28.8 volts. It provides 5 watts @ 5 volts for the POINTBus and dissipates 5 watts @ 28.8 volts.

The ControlNet adapter provides a maximum backplane output current of 1.0A. See the Specifications section of this manual for:

- backplane current consumption for each POINT I/O catalog number
- current consumption for each of the POINT I/O modules connected to the 1734 adapter

Extend backplane current beyond 1.0A with a 1734-EP24DC Backplane Extension Power Supply.

- Use a 1734-EP24DC power supply to supply up to an additional 1.3A of backplane current.
- Use multiple 1734-EP24DC power supplies to reach the maximum limit of 63 base modules if 25 or fewer of these modules are analog.

Set the Node Address

Set the node address using the 2-position thumbwheel switch. Valid settings range from 01 to 99. Press either the + or - buttons to change the number.

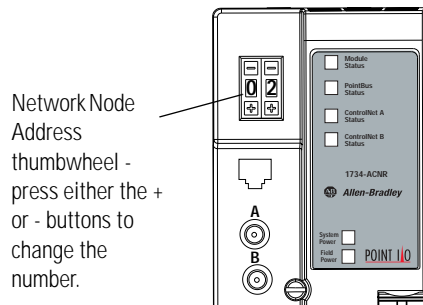

43248

Install the Adapter

To install the adapter on the DIN rail prior to installing other base units, proceed as follows:

ATTENTION



You must use Series C POINT I/O modules with the 1734-ACNR adapter. Series A and B POINT I/O modules will not work with the 1734-ACNR adapter.

1. Position the adapter vertically above the DIN rail.
2. Press down firmly to install the adapter on the DIN rail.

The locking mechanism will lock the adapter to the DIN rail.

WARNING



If you connect or disconnect the ControlNet cable with power applied to this module or any device on the network, an electrical arc can occur. This could cause an explosion in hazardous location installations.

Be sure that power is removed or the area is nonhazardous before proceeding.

3. Set the node address on the node address thumbwheel.
4. Remove the safety end cap by sliding it up.

This exposes the backplane and power interconnections.